

MM PRO 16SD / MM PRO 16 SD-3D SOUND CARD

Reference Guide

Version 1.0

- **Microsoft, MS-DOS and Windows** are registered trademark of **Microsoft Corp.**
- All other company or product names are trademarks or registered trademarks or service marks of their respective owners.

Part 15 FCC Compliance Statement (FCC ID : I38-SN96120)

This device complies with Part 15 of FCC Rules. Operation is subject to the following two conditions:

1. This device may not cause harmful interference, and
2. This device must accept any interference received, including interference that may cause undesired operation.

Notice

This equipment has been tested and found to comply with the limits of a Class B digital device, pursuant to Part 15 of the FCC Rules. These limits are designed to provide reasonable protection against harmful interference in a residential installation. This equipment generates, uses and can radiate radio frequency energy and, if not installed and used in accordance with the instructions, may cause harmful interference to radio communications. However, there is no guarantee that interference will not occur in a particular installation, if this equipment does cause harmful interference to radio or television reception, which can be determined by turning the equipment off and on, the user is encouraged to try to correct the interference by one or more of the following measures:

- Reorient or relocate the receiving antenna.
- Increase the separation between the equipment and receiver.
- Connect the equipment into an outlet on a circuit different from that to which the receiver is connected.
- Consult the dealer or an experienced radio/TV technician for help.

Caution

To comply with the limits for the Class B digital device according to Part 15 of FCC Rules, this device must be installed in computer equipment certified to comply with the Class B limits. All cables used to connect the computers and peripherals must be shielded and grounded. Operation with non-certified/shielded cables may result in radio/TV interference.

Modification

Any modification not expressly approved by the manufacturer of this device could void the user's authority to operate the device.

Sound Card Layout

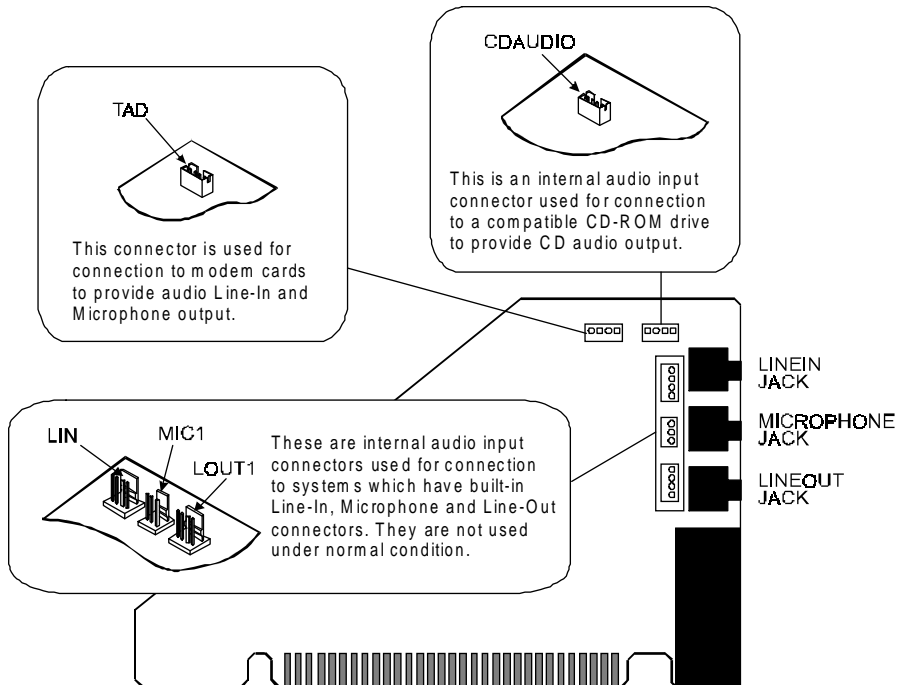

Technical Specifications

- Compatibility
 - Sound Blaster 2.0 and Sound Blaster Pro II compatibility
 - AdLib compatibility
 - General MIDI compatibility
 - MPU401 UART compatibility
 - ISA PnP compatibility
- Built-in 3D Sound Effects
- 16/8-bit Stereo Digital Sound Recording and Playback
 - Interrupt driven, 8-bit DMA or programmable I/O transfer
 - Selectable sampling up to 44.1kHz
 - Software support for 16-bit playback
- Stereo FM synthesizer producing 20 independent stereo voices of FM synthesized sound.
- Stereo Analog/Digital Mixer:
 - Digital recording source from mono microphone input
- Master and Mixer Volume Control
 - Individual volume control for:
 - Mono microphone audio (8 steps in Windows/8 steps in DOS)
 - Stereo CD audio/line-in (16 steps in Windows/16 steps in DOS)
 - Stereo FM synthesizer (16 steps in Windows/16 steps in DOS)
 - Stereo digital voice (16 steps in Windows/16 steps in DOS)
 - Stereo master volume (16 steps in Windows/16 steps in DOS)